

1. Strip approximately 40mm of the cable jacket.

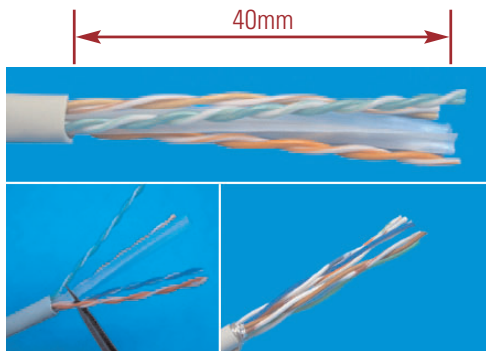

2. Follow the color-coding to position T568A or T568B wiring.

T568A

- Pin 1** White/Green
- Pin 2** Green
- Pin 3** White/Orange
- Pin 4** Blue
- Pin 5** White/Blue
- Pin 6** Orange
- Pin 7** White/Brown
- Pin 8** Brown

T568B

- Pin 1** White/Orange
- Pin 2** Orange
- Pin 3** White/Green
- Pin 4** Blue
- Pin 5** White/Blue
- Pin 6** Green
- Pin 7** White/Brown
- Pin 8** Brown

3. Follow the wiring sticker to place the wires into IDC slot.
Make sure to keep the pairs twisted as long as possible.
4. Punch the wires with a 110 or Krone impact tool and cut off the surplus wires.

Unshielded Type:

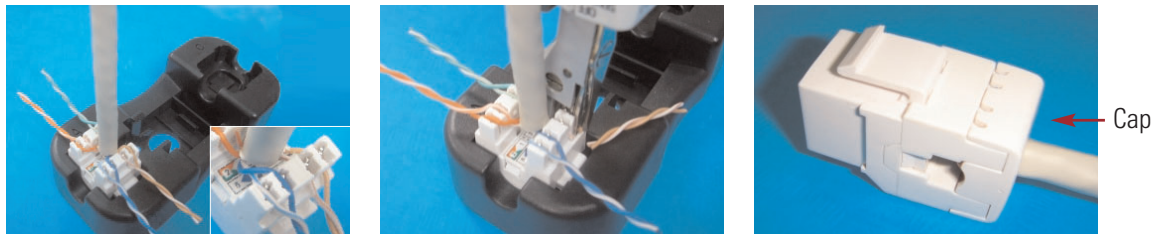

5. Snap in the IDC cap to fix the wires, and finish the installation.

Shielded Type:

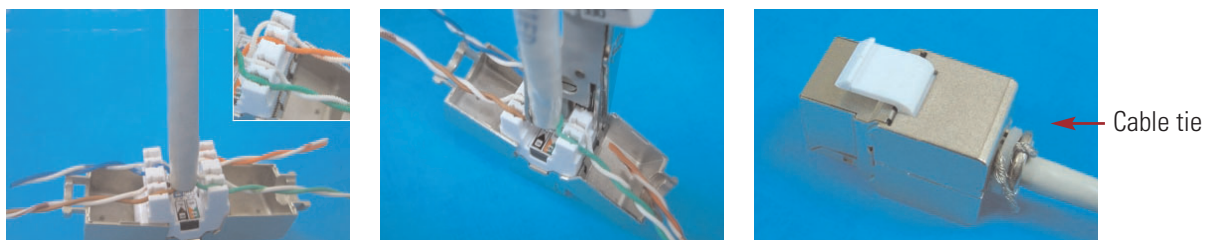

5. Tie up the cable by cable tie, and finish the installation.